

# The High-Security Series

HS427-S • HS430-S

Full-Height Turnstile (Single) • Interior & Exterior Application

HS439-S • HS448-S

Controlled Access manufactures the most reliable full-height turnstiles available. The High-Security Series units can be engineered to meet all your security and control requirements, and can be created as stand-alone units, or as part of an integrated system. Available in stainless steel, powder coat or a hot-dipped galvanized finish, these units can be fitted for any application with leading edge technology and features.

## Controls and Interfaces

- Biometric Integration
- Card Readers
- Electronic/LCD Counters
- Metal Detection
- Fail-Open or Fail-Secure Locking
- Push-Button and Wireless Remotes
- Manual Key Override – both directions
- Indicator Lights



## Size Options

(pedestrian clearance):

- HS427-S: 27" (686mm)
- HS430-S: 30" (782mm)
- HS439-S: 39" (991mm)
- HS448-S: 48" (1219mm)

**304 Stainless,  
No. 4 Satin finish (shown)**

Also available in  
hot-dipped galvanized or  
powder coat finishes.

Optional end caps  
available.  
(inset photo below).



**We're the #1 Choice  
of Top Architects,  
Security Pros and  
Government Engineers**

*For two decades, our company has been the globally trusted name in pedestrian control equipment. Made in Ohio and shipped worldwide, we are the first choice of leading architects, facility managers, security consultants and government engineers. Whether your project requires high-security, full-height turnstiles, waist-high units, or matching ADA accessible gates, Controlled Access is the secure choice. And, we're experienced in access control systems, from card readers to biometric scanning, to give you the power to control access.*

 Made in Ohio...  
In-Service World-Wide

	Depth	Width	Passage Width	Passage Height	Overall Height
	A*	B*	C*	D*	E*
HS427-S	54" 1372mm	62" 1575mm	27" 686mm	84" 2134mm	91" 2311mm
HS430-S	56" 1422mm	66" 1676mm	30" 762mm	84" 2134mm	91" 2311mm
HS439-S	68" 1727mm	84" 2134mm	39" 990mm	84" 2134mm	91" 2311mm
HS448-S	93" 2362mm	106" 2692mm	48" 1219mm	84" 2134mm	91" 2311mm

\* See CAD drawings on reverse side.



**Check Inn Systems** a division of Consulting Professional Engineers Pty. Ltd.

Factory 13 • 38 Christensen Street • Cheltenham VIC 3192 Australia • Ph: +61 3 9555 5444 • Fax: +61 3 9555 5445 • Mobile: 0418 338255  
E-mail: sales@checkinn.com.au • [www.checkinn.com.au](http://www.checkinn.com.au)

# The High-Security Series

HS427-S • HS430-S

## Full-Height Turnstile (Single) • Interior & Exterior Application

HS439-S • HS448-S

### Applications:

Ideal for controlling orderly flow of foot traffic in both indoor and outdoor settings

### Product Features:

Materials and Finishes available in your choice of:

- Hot dipped galvanized carbon steel
- Polyester enamel on carbon steel (standard color is black/ other colors available upon request)
- Our signature 304 Stainless steel/ No. 4 satin finish

### Design & Construction:

- Designed for secure operation with aesthetics in mind
- Featuring fully welded exterior components
- Minimal exposed hardware
- Heavy gauge materials meeting ASTM standards

### Controller &

#### Access Control Operation:

- Self-centering control head with adjustable hydraulic shock suppression
- Hardened tool steel locking bars, cam and roller assemblies
- Permanently lubricated bearings
- All units are available in clockwise, counter-clockwise or bi-directional passage

### Measures:

#### HS427-S

Size of opening (pedestrian clearance)

HS427-S 27" (686mm)

#### Arm and Barrier Tubing Sizes

1 1/2" diameter 14 gauge (38mm) - Standard

1 3/4" diameter 14 gauge (44mm) - Optional

Width	Depth
62" (1575mm)	54" (1372mm)

#### HS430-S

Size of opening (pedestrian clearance)

HS430-S 30" (762mm)

#### Arm and Barrier Tubing Sizes

1 1/2" diameter 14 gauge (38mm) - Standard

1 3/4" diameter 14 gauge (44mm) - Optional

Width	Depth
66" (1676mm)	56" (1422mm)

Measures: (continued)

#### HS439-S

Size of opening (pedestrian clearance)

HS439-S 39" (991mm)

#### Arm and Barrier Tubing Sizes

1 3/4" diameter 14 gauge (44mm)

Width	Depth
84" (2134mm)	68" (1727mm)

#### HS448-S

Size of opening (pedestrian clearance)

HS448-S 48" (1219mm)

#### Arm and Barrier Tubing Sizes

1 3/4" diameter 14 gauge (44mm)

Width	Depth
106" (2692mm)	93" (2362mm)

### All models:

- Overall exterior height 91" (2311mm)
- Pedestrian walk through height 84" (2134mm)

### Options:

- Electronic locking module featuring heavy-duty 24 vdc pull-type industrial solenoids and card reader interface
- Available in Fail-Safe (open on power failure) or Fail-Lock (lock on power failure modes)
- Can interface with card readers, computer attendance systems, coin and token acceptors, push buttons, wireless remote controls and metal detectors
- Electronic 6 digit resettable counter with LCD display and ten-year lithium battery
- Vertical Graphic Array (VGA) red x / green arrow
- Additional options available on request

### Matching Swing Gate available

(see model HS336 Manual Passage Gate information)

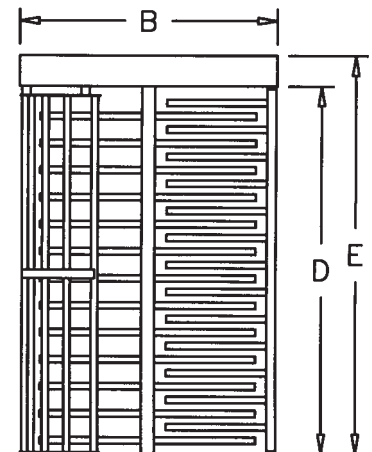
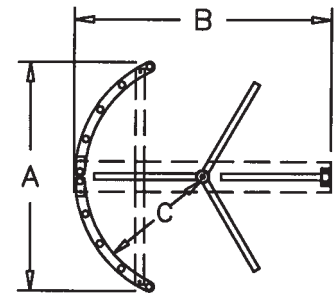

### Electrical Specifications:

Command module input 110-240 VAC (2 amp-1 amp) 50-60 Hz; control voltage 24 VDC. All electrical components are UL recognized and CSA certified.

### Standards and Codes:

Austenitic stainless steel: ASTM A240, A249, A276

Hot rolled steel: AISI C-1020, AISI C-1018

Hot dipped galvanizing: ASTM A-143, ASTM A-153-80

Stainless steel fasteners: ASTM A-320

American Welding Society (AWS) Standard D 1.1

### Warranty:

Units are warranted against defects in materials and workmanship for a period of one year from date of delivery. See warranty information for specific details.



Check Inn Systems a division of Consulting Professional Engineers Pty. Ltd.

Factory 13 • 38 Christensen Street • Cheltenham VIC 3192 Australia • Ph: +61 3 9555 5444 • Fax: +61 3 9555 5445 • Mobile: 0418 338255  
E-mail: sales@checkinn.com.au • [www.checkinn.com.au](http://www.checkinn.com.au)

# The High-Security Series

HS427-T

Full-Height Turnstile (Tandem) • Interior & Exterior Application

HS430-T

The Turnstile Factory is the nation's leading manufacturer of turnstiles and ADA gates. The High-Security Series units can be engineered to meet all your security and control requirements, and can be created as stand-alone units, or as part of an integrated system. Available in stainless steel, powder coat or a hot-dipped galvanized finish, these units can be fitted for any application with leading edge technology and features.

## Controls and Interfaces

- Biometric Integration
- Card Readers
- Electronic/LCD Counters
- Metal Detection
- Fail-Open or Fail-Secure Locking
- Push-Button and Wireless Remotes
- Manual Key Override – both directions
- Indicator Lights



**Size Options** (pedestrian clearance):

**HS427-T:** 27" (686mm)

**HS430-T:** 30" (782mm)

Optional end caps available (inset photo at right).

Hot-dipped Galvanized finish (shown above)

Also available in stainless steel or powder coat finishes.

## We're the #1 Choice of Top Architects, Security Pros and Government Engineers

*For two decades, our company has been the globally trusted name in pedestrian control equipment. Made in Ohio and shipped worldwide, we are the first choice of leading architects, facility managers, security consultants and government engineers. Whether your project requires high-security, full-height turnstiles, waist-high units, or matching ADA accessible gates, Controlled Access is the secure choice. And, we're experienced in access control systems, from card readers to biometric scanning, to give you the power to control access.*



Made in Ohio...  
In-Service World-Wide

	Depth	Width	Passage Width	Passage Height	Overall Height
	A*	B*	C*	D*	E*
HS427-T	54" 1372mm	94" 2388mm	27" 686mm	84" 2134mm	91" 2311mm
HS430-T	56" 1422mm	102" 2591mm	30" 762mm	84" 2134mm	91" 2311mm

\* See CAD drawings on reverse side.



**Check Inn Systems** a division of Consulting Professional Engineers Pty. Ltd.

Factory 13 • 38 Christensen Street • Cheltenham VIC 3192 Australia • Ph: +61 3 9555 5444 • Fax: +61 3 9555 5445 • Mobile: 0418 338255  
E-mail: sales@checkinn.com.au • [www.checkinn.com.au](http://www.checkinn.com.au)

# The High-Security Series

HS427-T

## Full-Height Turnstile (Tandem) • Interior & Exterior Application

HS430-T

### Applications:

Ideal for controlling orderly flow of foot traffic in both indoor and outdoor settings

### Product Features:

Materials and Finishes available in your choice of:

- Hot dipped galvanized carbon steel
- Polyester enamel on carbon steel (standard color is black / other colors available upon request)
- Our signature 304 Stainless steel / No. 4 satin finish

### Design & Construction:

- Designed for secure operation with aesthetics in mind
- Featuring fully welded exterior components
- Minimal exposed hardware
- Heavy gauge materials meeting ASTM standards

### Controller &

#### Access Control Operation:

- Self-centering control head with adjustable hydraulic shock suppression
- Hardened tool steel locking bars, cam and roller assemblies
- Permanently lubricated bearings
- All units are available in clockwise, counter-clockwise or bi-directional passage

### Measures:

#### HS427-T

Size of opening (pedestrian clearance)  
HS427-T 27" (686mm)

#### Arm and Barrier Tubing Sizes

1 1/2" diameter 14 gauge (38mm)  
1 3/4" diameter 14 gauge (44mm)

#### Width

94" (2388mm)

#### Depth

54" (1372mm)

#### HS430-T

Size of opening (pedestrian clearance)  
HS430-T 30" (762mm)

#### Arm and Barrier Tubing Sizes

1 1/2" diameter 14 gauge (38mm) - Standard  
1 3/4" diameter 14 gauge (44mm) - Optional

#### Width

102" (2591mm)

#### Depth

56" (1422mm)

### All models:

- Overall exterior height 91" (2311mm)
- Pedestrian walk through height 84" (2134mm)

### Options:

- Electronic locking module featuring heavy-duty 24 vdc pull-type industrial solenoids and card reader interface
- Available in Fail-Safe (open on power failure) or Fail-Lock (lock on power failure modes)
- Can interface with card readers, computer attendance systems, coin and token acceptors, push buttons, wireless remote controls and metal detectors
- Electronic 6 digit resettable counter with LCD display and ten-year lithium battery
- Vertical Graphic Array (VGA) red x / green arrow
- Additional options available on request

### Matching Swing Gate available

(see model HS336 Manual Passage Gate information)

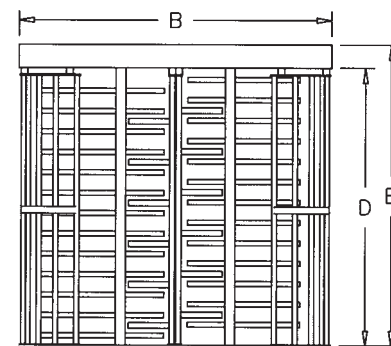
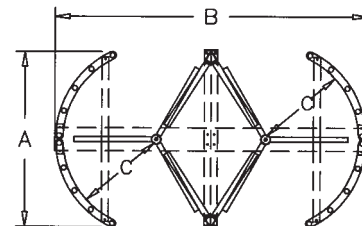

TYPE T-TANDEM

### Electrical Specifications:

Command module input 110-240 VAC (2 amp-1 amp) 50-60 Hz; control voltage 24 VDC. All electrical components are UL recognized and CSA certified.

### Standards and Codes:

Austenitic stainless steel: ASTM A240, A249, A276  
Hot rolled steel: AISI C-1020, AISI C-1018  
Hot dipped galvanizing: ASTM A-143, ASTM A-153-80  
Stainless steel fasteners: ASTM A-320  
American Welding Society (AWS) Standard D 1.1

### Warranty:

Units are warranted against defects in materials and workmanship for a period of one year from date of delivery. See warranty information for specific details.

### ENDURO™ Electronic Control Head

**EA** Controlled Traffic flow both directions

**EB** Controlled Traffic flow one direction, uncontrolled opposite direction

**EC** Controlled Traffic flow one direction, no traffic flow opposite direction

### ENDURO™ Manual Control Head

**MD** Uncontrolled traffic flow one direction, no traffic flow opposite direction

**MF** Uncontrolled traffic flow both directions

**MG** Key controlled each direction



**Check Inn Systems** a division of Consulting Professional Engineers Pty. Ltd.

Factory 13 • 38 Christensen Street • Cheltenham VIC 3192 Australia • Ph: +61 3 9555 5444 • Fax: +61 3 9555 5445 • Mobile: 0418 338255  
E-mail: sales@checkinn.com.au • [www.checkinn.com.au](http://www.checkinn.com.au)

## Full-Height Turnstiles • Interior & Exterior Application

### Block out weather and noise!

The Monitor RD70 Series is a full security card access, tamper-resistant revolving door. It is designed for locations requiring improved visitor security or as the barrier between production and office areas. Quiet in day/night mode, it can provide free passage during regular working hours and controlled passage after hours with card access or biometrics.



### We're the #1 Choice of Top Architects, Security Pros and Government Engineers

*For two decades, our company has been the globally trusted name in pedestrian control equipment. Made in Ohio and shipped worldwide, we are the first choice of leading architects, facility managers, security consultants and government engineers. Whether your project requires high-security, full-height turnstiles, waist-high units, or matching ADA accessible gates, Controlled Access is the secure choice. And, we're experienced in access control systems, from card readers to biometric scanning, to give you the power to control access.*

 Made in Ohio...  
In-Service World-Wide

### Measurements:

Exterior Height: 94" to 120" available

Width: 72"

Pedestrian Clearance: 30"



Available as a Metal-Detect Door where higher security needs exist. Metal detection and bullet-resistant panels are available in varying performance specs based on your application.



**Check Inn Systems** a division of *Consulting Professional Engineers Pty. Ltd.*

Factory 13 • 38 Christensen Street • Cheltenham VIC 3192 Australia • Ph: +61 3 9555 5444 • Fax: +61 3 9555 5445 • Mobile: 0418 338255  
E-mail: [sales@checkinn.com.au](mailto:sales@checkinn.com.au) • [www.checkinn.com.au](http://www.checkinn.com.au)

# The Monitor RD70

RD70

## Full-Height Turnstiles • Interior & Exterior Application

### Applications:

Block out weather and noise!

The Monitor RD70 Series is a full security card access, tamper-resistant revolving door that's designed for locations requiring improved visitor security or as the barrier between production and office areas. Quiet in day/night mode, it can provide free passage during regular working hours and controlled passage after hours with card access or biometrics. It is crafted of 6005-T6 aluminum extrusions and features GE's transparent Lexan polycarbonate cage panels and arms for an un-caged appearance.

### Product Features:

Materials and Finishes available in your choice of:

- Available in your choice of Clear, Dark Bronze or Black
- Performance features include automatic indent Feather-Touch action – that includes shock suppressor technology and a non-entrapment design

### Design & Construction:

- Designed for secure operation with aesthetics in mind
- Features minimal exposed hardware and meets ASTM standards

### Controller &

### Access Control Operation:

- Self-centering control head with adjustable hydraulic shock suppression
- Hardened tool steel locking bars, cam and roller assemblies
- Permanently lubricated bearings
- Available in clockwise, counter-clockwise or bi-directional passage

### Measures:

Exterior Height  
94" to 120" available  
Width  
72"  
Pedestrian Clearance  
30"

### Options:

- Electronic locking module featuring heavy-duty 24 vdc pull-type industrial solenoids and card reader interface
- Available in Fail-Safe (open on power failure) or Fail-Lock (lock on power failure modes)
- Can interface with card readers, computer attendance systems, coin and token acceptors, push buttons, wireless remote controls and metal detectors
- Electronic 6 digit resettable counter with LCD display and ten-year lithium battery
- Vertical Graphic Array (VGA) red x / green arrow
- Additional options available on request
- Level-one bullet resistant armor
- Traffic light control module with low voltage LED's
- Control Console with remote alarms and push buttons
- Low voltage canopy lighting

### Matching Swing Gate available

(see model SFH36 Manual Passage Gate information)

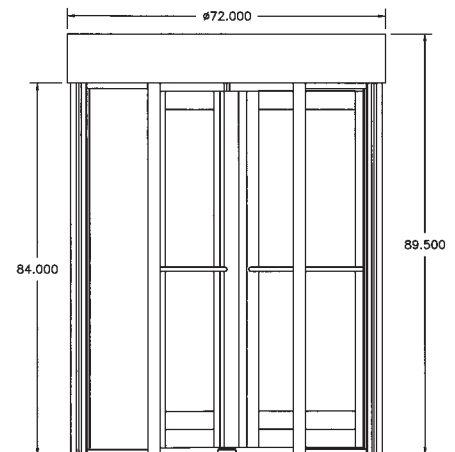
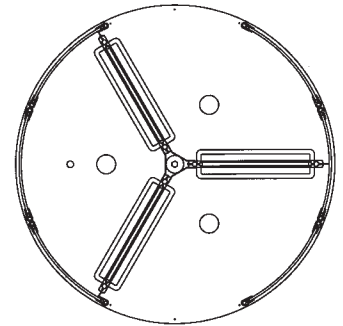

### Electrical Specifications:

Command module input 110-240 VAC (2 amp-1 amp) 50-60 Hz; control voltage 24 VDC. All electrical components are UL recognized and CSA certified.

### Warranty:

Units are warranted against defects in materials and workmanship for a period of one year from date of delivery. See warranty information for specific details.



**Check Inn Systems** a division of Consulting Professional Engineers Pty. Ltd.

Factory 13 • 38 Christensen Street • Cheltenham VIC 3192 Australia • Ph: +61 3 9555 5444 • Fax: +61 3 9555 5445 • Mobile: 0418 338255  
E-mail: sales@checkinn.com.au • [www.checkinn.com.au](http://www.checkinn.com.au)