

The PassThru Series

PT-S

Waist-Height Turnstiles • Bolt Down - Interior & Exterior Application

PT-R • PT-Z

The PassThru™ Series is ideal in demanding situations where you want a more open, stylish look. It is made for years of reliable service in high traffic/volume applications be they indoors or outside. The cabinets are constructed of heavy 14-gauge, 300 series satin stainless steel and feature our Enduro Control Head (with auto indexing and shock suppression technology).



PT-S



PT-Z

Trapezoid-end with solid surface top



PT-R

Round-end with solid surface top



Optional ticket box



Optional coin box

We're the #1 Choice of Top Architects, Security Pros and Government Engineers

For two decades, our company has been the globally trusted name in pedestrian control equipment. Made in Ohio and shipped worldwide, we are the first choice of leading architects, facility managers, security consultants and government engineers. Whether your project requires high-security, full-height turnstiles, waist-high units, or matching ADA accessible gates, Controlled Access is the secure choice. And, we're experienced in access control systems, from card readers to biometric scanning, to give you the power to control access.



Made in Ohio...
In-Service World-Wide

PT-S, PT-R, PT-Z

Stainless Top:
Interior/Exterior Application

Solid Surface Top:
Interior Application Only



Check Inn Systems a division of Consulting Professional Engineers Pty. Ltd.

Factory 13 • 38 Christensen Street • Cheltenham VIC 3192 Australia • Ph: +61 3 9555 5444 • Fax: +61 3 9555 5445 • Mobile: 0418 338255
E-mail: sales@checkinn.com.au • www.checkinn.com.au

The PassThru Series

PT-S

Waist-Height Turnstiles • Bolt Down - Interior & Exterior Application

PT-R • PT-Z

Applications:

This series is made for years of reliable service in either indoor or outdoor high traffic / volume environments where you seek a more open, stylish look.

Product Features:

Materials and Finishes:

- Units are finished in your choice of:
- Our signature 304 stainless steel/ No. 4 satin finish

Design & Construction:

- Designed for secure & reliable operation with aesthetics in mind
- Cabinet inner and outer shells and cover are constructed of (14 gauge) 304 stainless steel/ No. 4 satin finish
- Arms constructed of 1-5/16" (33mm) diameter, (12 gauge) stainless
- Hub 4-1/2" (114mm) o.d. also made from stainless
- Minimal exposed hardware
- Stainless Top: Interior/Exterior Application
- Solid Surface Top: Interior Application Only



Measures:

Height: 38" (965 mm)
 Width: 48.25" (1226mm)
 Depth: 10.25" (260mm)

Controller & Access Control Operation:

- Self-centering control head with adjustable hydraulic shock suppression
- Hardened tool steel locking bars, cam and roller assemblies
- Permanently lubricated bearings
- All units are available in clockwise, counter-clockwise or bi-directional passage
- Key-lock Feature - Control direction of travel manually by key (to lock /unlock), or may be used to override electronic controls

Options:

- Electronic lock modules include heavy-duty 24 vdc pull-type industrial solenoids:
- Available in each separate direction: fail-safe (open on power failure) or fail-lock (lock on power failure) modes
- Interfacing to card readers, computer attendance systems, coin and token acceptors, push buttons and wireless remote controls
- Electronic 6 digit re-settable counter with LCD display and ten-year lithium battery
- Additional options available on request

Our matching ADA gate (model FP500-ADA with optional motorization) is available for the PassThru Series.

The PassThru is also available as an Optical model (PT-O).

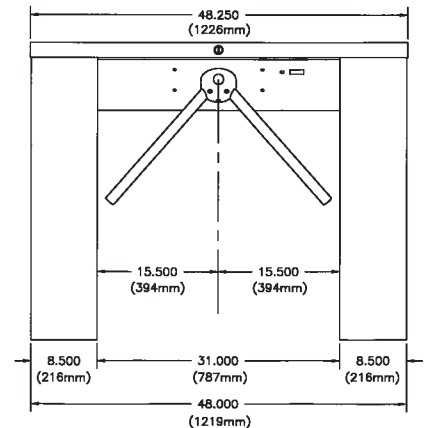
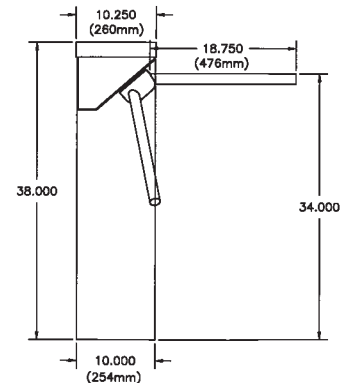

Electrical Specifications:

Command module input 110-240 VAC (2 amp-1 amp) 50-60 Hz; control voltage 24 VDC. All electrical components are UL recognized and CSA certified.

Standards and Codes:

Austenitic stainless steel: ASTM A240, A249, A276
 Hot rolled steel: AISI C-1020, AISI C-1018
 Hot dipped galvanizing: ASTM A-143, ASTM A-153-80
 Stainless steel fasteners: ASTM A-320
 American Welding Society (AWS) Standard D 1.1

Warranty:

Units are warranted against defects in materials and workmanship for a period of one year from date of delivery. See warranty information for specific details.

ENDURO™ Electronic Control Head

- EA** Controlled Traffic flow both directions
- EB** Controlled Traffic flow one direction, uncontrolled opposite direction
- EC** Controlled Traffic flow one direction, no traffic flow opposite direction

ENDURO™ Manual Control Head

- MD** Uncontrolled traffic flow one direction, no traffic flow opposite direction
- MF** Uncontrolled traffic flow both directions
- MG** Key controlled each direction



Check Inn Systems a division of Consulting Professional Engineers Pty. Ltd.

Waist-Height Turnstiles • Interior & Exterior Application

The PassThru™ Series OPTICAL is our barrier free solution for demanding situations where you want a more open, stylish look. It is made for years of reliable service in high traffic/volume interior and exterior applications when finished with a stainless top. Also, it can feature a designer solid-surface top for interior applications.

Using a non-restrictive method to control traffic flow, these "optical" units are ideally suited for office personnel entrances where the majority of the people enter using an ID card. It allows for rapid pedestrian advancement and barrier free ADA access, while preventing "tail-gating" by those without credentials. The cabinets are constructed of heavy 14-gauge, 300 series satin stainless steel and will integrate with all standard access control equipment.



We're the #1 Choice of Top Architects, Security Pros and Government Engineers

For two decades, our company has been the globally trusted name in pedestrian control equipment. Made in Ohio and shipped worldwide, we are the first choice of leading architects, facility managers, security consultants and government engineers. Whether your project requires high-security, full-height turnstiles, waist-high units, or matching ADA accessible gates, Controlled Access is the secure choice. And, we're experienced in access control systems, from card readers to biometric scanning, to give you the power to control access.



Made in Ohio...
In-Service World-Wide

PT-O

Stainless Top:
Interior/Exterior Application

Solid Surface Top:
Interior Application Only



Check Inn Systems a division of *Consulting Professional Engineers Pty. Ltd.*

Factory 13 • 38 Christensen Street • Cheltenham VIC 3192 Australia • Ph: +61 3 9555 5444 • Fax: +61 3 9555 5445 • Mobile: 0418 338255
E-mail: sales@checkinn.com.au • www.checkinn.com.au

Waist-Height Turnstiles • Interior & Exterior Application

Applications:

This interior/exterior application optical unit features our signature 304 stainless steel construction (No. 4 brushed satin finish) and is ideally suited for office personnel entrances where the majority of people enter using an ID card.

Product Features:

Materials and Finishes:

Units are finished in your choice of:

- Our signature 304 stainless steel

Design & Construction:

Measures:

Height: 38" (965 mm)

Width: 48.25" (1226mm)

Depth: 10.25" (260mm)

- Designed for secure & reliable operation with aesthetics in mind
- Cabinet inner and outer shells and cover are constructed of (14 gauge) 304 stainless steel/ No. 4 satin finish
- Minimal exposed hardware
- Optical sensors provide for passage for up to 30 people/minute
- Visual and Audible annunciation is provided status of passageway (open or closed), indication of valid card read, or alarm condition
- Horizontal graphic arrays (HGAs) solid state/maintenance free

- Optical sensors to prevent unauthorized "crawling" thru lane
- Distinctive tones for valid card and alarm condition with adjustable volume control (82db max)/buzzer sounds on alarm condition
- Power Requirements: power supply input 100/120/220/230/240 VAC 50/60hz output – 24 vdc@ 2 amps per passageway
- Optical Unit measures: 27 1/4" long x 37" high x 8 5/8" wide
- All components are designed by Sentronic® International and made in the USA
- Stainless Top: Interior/Exterior Application
- Solid Surface Top: Interior Application Only



Options:

- Optional console device can remotely monitor and control lane use
- Alarm outputs: n/c, n/o relay rated at 5 amp @ 24 vdc/auxiliary alarm output contacts provided for interface to building access control, fire/life safety, security, CCTV, and monitoring systems

The Pass-Thru is also available as an armed model (PT-S) with coin, ticket and scanner capabilities.

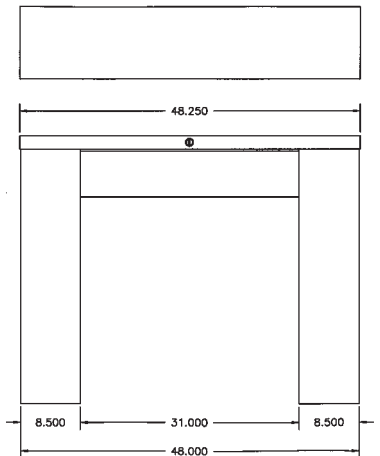
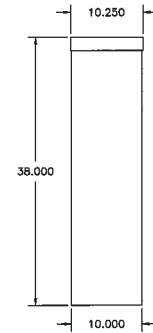

Electrical Specifications:

Command module input 110-240 VAC (2 amp-1 amp) 50-60 Hz; control voltage 24 VDC. All electrical components are UL recognized and CSA certified.

Standards and Codes:

Austenitic stainless steel: ASTM A240, A249, A276
Hot rolled steel: AISI C-1020, AISI C-1018
Hot dipped galvanizing: ASTM A-143, ASTM A-153-80
Stainless steel fasteners: ASTM A-320
American Welding Society (AWS) Standard D 1.1

Warranty:

Units are warranted against defects in materials and workmanship for a period of one year from date of delivery. See warranty information for specific details.

ENDURO™ Electronic Control Head

EA Controlled Traffic flow both directions

EB Controlled Traffic flow one direction, uncontrolled opposite direction

EC Controlled Traffic flow one direction, no traffic flow opposite direction

ENDURO™ Manual Control Head

MD Uncontrolled traffic flow one direction, no traffic flow opposite direction

MF Uncontrolled traffic flow both directions

MG Key controlled each direction



Check Inn Systems a division of Consulting Professional Engineers Pty. Ltd.